

VO

Curva a 45° Orientabile
Adjustable 45° Elbow

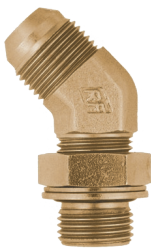
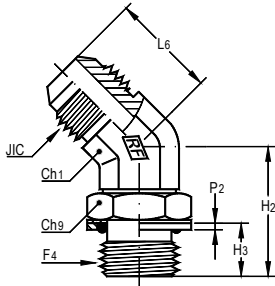

Codice Code	∅ est. tubo Tube O.D.	JIC	F4 (BSPP)	Ch1	Ch9	H2	H3	L6	P2
VO-06-1/8	6	7/16"-20	1/8"	12	14	26,5	8	18,5	1,2
VO-06-1/4	6	7/16"-20	1/4"	14	19	29	12	21	1,8
VO-08-1/8	8	1/2"-20	1/8"	14	14	26,5	8	19,5	1,2
VO-08-1/4	8	1/2"-20	1/4"	14	19	29	12	21	1,8
VO-08-3/8	8	1/2"-20	3/8"	19	24	33	12	21	1,8
VO-10-1/4	10	9/16"-18	1/4"	14	19	29	12	21	1,8
VO-10-3/8	10	9/16"-18	3/8"	19	24	33	12	22	1,8
VO-12-1/4	12	3/4"-16	1/4"	19	19	30	12	25	1,8
VO-12-3/8	12	3/4"-16	3/8"	19	24	33	12	25	1,8
VO-12-1/2	12	3/4"-16	1/2"	22	27	38,5	14	25	1,8
VO-16-3/8	14÷16	7/8"-14	3/8"	22	24	35	12	28	1,8
VO-16-1/2	14÷16	7/8"-14	1/2"	22	27	38,5	14	28	1,8
VO-16-3/4	14÷16	7/8"-14	3/4"	27	36	44	16	30	1,8
VO-20-1/2	18-20	1.1/16"-12	1/2"	27	27	40,5	14	32,5	1,8
VO-20-3/4	18-20	1.1/16"-12	3/4"	27	36	44	16	32,5	1,8
VO-20-1	18-20	1.1/16"-12	1"	33	41	47	18	35,5	2,5
VO-25-3/4	25	1.5/16"-12	3/4"	33	36	47	16	37	1,8
VO-25-1	25	1.5/16"-12	1"	33	41	47	18	37	2,5
VO-25-1.1/4	25	1.5/16"-12	1.1/4"	41	50	48,5	20	39	2,5
VO-30-1	30-32	1.5/8"-12	1"	41	41	48,5	18	40,5	2,5
VO-30-1.1/4	30-32	1.5/8"-12	1.1/4"	41	50	48,5	20	40,5	2,5
VO-38-1.1/2	38	1.7/8"-12	1.1/2"	48	60	48,5	22	45	2,5

MA

Maschio Alto
Long Male Connector

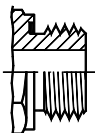
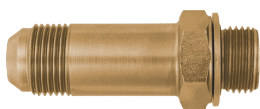
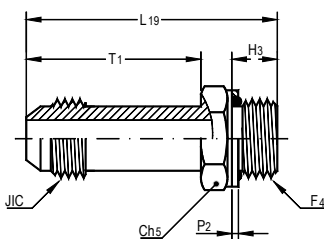

Codice Code	∅ est. tubo Tube O.D.	JIC	F4 (BSPP)	Ch5	H3	L19	P2	T1
MA-06-1/8	6	7/16"-20	1/8"	16	8	50,5	1,2	35,5
MA-06-1/4	6	7/16"-20	1/4"	19	12	56	1,8	35,5
MA-08-1/8	8	1/2"-20	1/8"	16	8	52	1,2	37
MA-08-1/4	8	1/2"-20	1/4"	19	12	57,5	1,8	37
MA-08-3/8	8	1/2"-20	3/8"	24	12	57,5	1,8	37
MA-10-1/4	10	9/16"-18	1/4"	19	12	60	1,8	39,5
MA-10-3/8	10	9/16"-18	3/8"	24	12	60	1,8	39,5
MA-12-1/4	12	3/4"-16	1/4"	22	12	68,5	1,8	48
MA-12-3/8	12	3/4"-16	3/8"	24	12	68,5	1,8	48
MA-12-1/2	12	3/4"-16	1/2"	27	14	72	1,8	48
MA-16-3/8	14÷16	7/8"-14	3/8"	24	12	74	1,8	53
MA-16-1/2	14÷16	7/8"-14	1/2"	27	14	77	1,8	53
MA-16-3/4	14÷16	7/8"-14	3/4"	36	16	81	1,8	53
MA-20-1/2	18-20	1.1/16"-12	1/2"	27	14	88,5	1,8	63,5
MA-20-3/4	18-20	1.1/16"-12	3/4"	36	16	91,5	1,8	63,5
MA-20-1	18-20	1.1/16"-12	1"	41	18	94	2,5	63,5
MA-25-3/4	25	1.5/16"-12	3/4"	36	16	100	1,8	72
MA-25-1	25	1.5/16"-12	1"	41	18	102,5	2,5	72
MA-25-1.1/4	25	1.5/16"-12	1.1/4"	50	20	106	2,5	72
MA-30-1	30-32	1.5/8"-12	1"	42	18	118,5	2,5	88
MA-30-1.1/4	30-32	1.5/8"-12	1.1/4"	50	20	122	2,5	88
MA-38-1.1/2	38	1.7/8"-12	1.1/2"	60	22	136,5	2,5	98,5

Raccordo disponibile anche con tenuta elastomerica ISO 1179-2.
Per ordinare: sostituire nel codice il prefisso MA con MAE.

Straight fitting available also with elastomeric sealing ISO 1179-2.
To order: substitute the code prefix MA with MAE.