

### 9M5

#### Maschio Male Connector

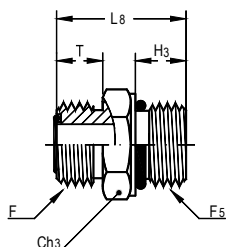

Codice Code	∅ est. tubo Tube O.D.	F (ORFS)	F5 (UNF)	Ch3	H3	L8	T
9M5-06-04	6	9/16"-18	7/16"-20	16	11	28,5	10
9M5-06-06	6	9/16"-18	9/16"-18	19	12	30,5	10
9M5-10-04	8-10	11/16"-16	7/16"-20	19	11	34	11
9M5-10-06	8-10	11/16"-16	9/16"-18	19	12	32	11
9M5-10-08	8-10	11/16"-16	3/4"-16	22	14	35	11
9M5-12-06	12	13/16"-16	9/16"-18	22	12	37,5	13
9M5-12-08	12	13/16"-16	3/4"-16	22	14	36,5	13
9M5-12-10	12	13/16"-16	7/8"-14	27	16	40,5	13
9M5-16-08	14÷16	1"-14	3/4"-16	27	14	45	15,5
9M5-16-10	14÷16	1"-14	7/8"-14	27	16	43	15,5
9M5-16-12	14÷16	1"-14	1.1/16"-12	32	18,5	47	15,5
9M5-20-10	18-20	1.3/16"-12	7/8"-14	32	16	50,5	17
9M5-20-12	18-20	1.3/16"-12	1.1/16"-12	32	18,5	48,5	17
9M5-20-16	18-20	1.3/16"-12	1.5/16"-12	38	18,5	50	17
9M5-25-12	25	1.7/16"-12	1.1/16"-12	38	18,5	54,5	17,5
9M5-25-16	25	1.7/16"-12	1.5/16"-12	38	18,5	50,5	17,5
9M5-25-20	25	1.7/16"-12	1.5/8"-12	50	18,5	52,5	17,5
9M5-32-16	30-32	1.11/16"-12	1.5/16"-12	46	18,5	58	17,5
9M5-32-20	30-32	1.11/16"-12	1.5/8"-12	50	18,5	52,5	17,5
9M5-38-24	38	2"-12	1.7/8"-12	55	18,5	54	17,5

### 9TOL5

#### "T" Orientabile in Linea Adjustable Branch Tee

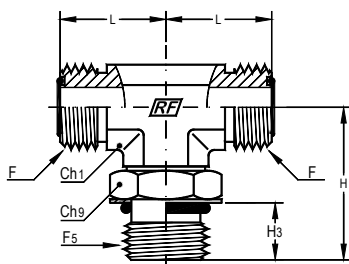

Codice Code	∅ est. tubo Tube O.D.	F (ORFS)	F5 (UNF)	Ch1	Ch9	H	H3	L
9TOL5-06-04	6	9/16"-18	7/16"-20	14	16	32,5	11	21,5
9TOL5-10-04	8-10	11/16"-16	7/16"-20	19	16	35	11	25
9TOL5-10-06	8-10	11/16"-16	9/16"-18	19	19	37	12	25
9TOL5-10-08	8-10	11/16"-16	3/4"-16	19	24	40,5	14	26,5
9TOL5-12-08	12	13/16"-16	3/4"-16	19	24	40,5	14	28
9TOL5-12-10	12	13/16"-16	7/8"-14	27	27	50	16	31
9TOL5-16-08	14÷16	1"-14	3/4"-16	27	24	45,5	14	33,5
9TOL5-16-10	14÷16	1"-14	7/8"-14	27	27	50	16	33,5
9TOL5-16-12	14÷16	1"-14	1.1/16"-12	30	36	55	18,5	36
9TOL5-20-10	18-20	1.3/16"-12	7/8"-14	30	27	51	16	37,5
9TOL5-20-12	18-20	1.3/16"-12	1.1/16"-12	30	36	55	18,5	37,5
9TOL5-20-16	18-20	1.3/16"-12	1.5/16"-12	37	41	59,5	18,5	41
9TOL5-25-16	25	1.7/16"-12	1.5/16"-12	37	41	59,5	18,5	41,5
9TOL5-32-20	30-32	1.11/16"-12	1.5/8"-12	41	50	62	18,5	44,5
9TOL5-38-24	38	2"-12	1.7/8"-12	48	55	66	18,5	49