

ORFS-GAS CILINDRICO

ORFS-BSPP



9VO

Curva a 45° Orientabile
Adjustable 45° Elbow

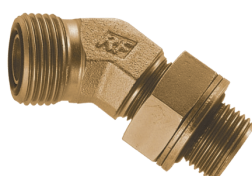
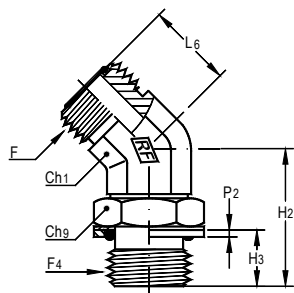

Codice Code	∅ est. tubo Tube O.D.	F (ORFS)	F4 (BSPP)	Ch1	Ch9	H2	H3	L6	P2
9VO-06-1/8	6	9/16"-18	1/8"	14	14	26,5	8	16	1,2
9VO-06-1/4	6	9/16"-18	1/4"	19	19	31,5	12	17,5	1,8
9VO-06-3/8	6	9/16"-18	3/8"	19	24	33,5	12	17,5	1,8
9VO-10-1/4	8-10	11/16"-16	1/4"	19	19	31,5	12	19	1,8
9VO-10-3/8	8-10	11/16"-16	3/8"	19	24	33,5	12	19	1,8
9VO-10-1/2	8-10	11/16"-16	1/2"	27	27	41,5	14	19,5	1,8
9VO-12-1/4	12	13/16"-16	1/4"	19	19	33	12	20,5	1,8
9VO-12-3/8	12	13/16"-16	3/8"	19	24	33,5	12	20,5	1,8
9VO-12-1/2	12	13/16"-16	1/2"	27	27	41,5	14	21	1,8
9VO-12-3/4	12	13/16"-16	3/4"	30	36	46,5	16	22	1,8
9VO-16-3/8	14÷16	1"-14	3/8"	27	24	34	12	23,5	1,8
9VO-16-1/2	14÷16	1"-14	1/2"	27	27	41,5	14	23,5	1,8
9VO-16-3/4	14÷16	1"-14	3/4"	30	36	46,5	16	24,5	1,8
9VO-20-1/2	18-20	1.3/16"-12	1/2"	30	27	45,5	14	26	1,8
9VO-20-3/4	18-20	1.3/16"-12	3/4"	30	36	46,5	16	26	1,8
9VO-20-1	18-20	1.3/16"-12	1"	37	41	51	18	29,5	2,5
9VO-25-3/4	25	1.7/16"-12	3/4"	37	36	46,5	16	30	1,8
9VO-25-1	25	1.7/16"-12	1"	37	41	51	18	30	2,5
9VO-25-1.1/4	25	1.7/16"-12	1.1/4"	41	50	52	20	32	2,5
9VO-32-1	30-32	1.11/16"-12	1"	41	41	52	18	32	2,5
9VO-32-1.1/4	30-32	1.11/16"-12	1.1/4"	41	50	52	20	32	2,5
9VO-38-1.1/2	38	2"-12	1.1/2"	48	60	52	22	37	2,5

9MA

Maschio Alto
Long Male Connector

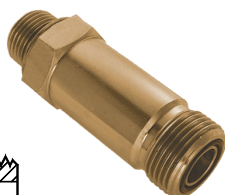
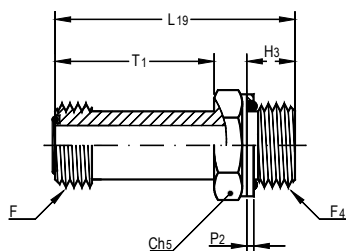

Codice Code	∅ est. tubo Tube O.D.	F (ORFS)	F4 (BSPP)	Ch5	H3	L19	P2	T1
9MA-06-1/8	6	9/16"-18	1/8"	16	8	49	1,2	34
9MA-06-1/4	6	9/16"-18	1/4"	19	12	54,5	1,8	34
9MA-06-3/8	6	9/16"-18	3/8"	24	12	54,5	1,8	34
9MA-10-1/4	8-10	11/16"-16	1/4"	19	12	57,5	1,8	37
9MA-10-3/8	8-10	11/16"-16	3/8"	24	12	57,5	1,8	37
9MA-10-1/2	8-10	11/16"-16	1/2"	27	14	61	1,8	37
9MA-12-1/4	12	13/16"-16	1/4"	22	12	67,5	1,8	44,5
9MA-12-3/8	12	13/16"-16	3/8"	24	12	65	1,8	44,5
9MA-12-1/2	12	13/16"-16	1/2"	27	14	68,5	1,8	44,5
9MA-12-3/4	12	13/16"-16	3/4"	36	16	72,5	1,8	44,5
9MA-16-3/8	14÷16	1"-14	3/8"	27	12	78,5	1,8	52,5
9MA-16-1/2	14÷16	1"-14	1/2"	27	14	76,5	1,8	52,5
9MA-16-3/4	14÷16	1"-14	3/4"	36	16	80,5	1,8	52,5
9MA-20-1/2	18-20	1.3/16"-12	1/2"	32	14	93,5	1,8	64
9MA-20-3/4	18-20	1.3/16"-12	3/4"	36	16	92	1,8	64
9MA-20-1	18-20	1.3/16"-12	1"	41	18	94,5	2,5	64
9MA-25-3/4	25	1.7/16"-12	3/4"	38	16	105,5	1,8	73
9MA-25-1	25	1.7/16"-12	1"	41	18	103,5	2,5	73
9MA-25-1.1/4	25	1.7/16"-12	1.1/4"	50	20	107	2,5	73
9MA-32-1	30-32	1.11/16"-12	1"	46	18	123,5	2,5	86,5
9MA-32-1.1/4	30-32	1.11/16"-12	1.1/4"	50	20	120,5	2,5	86,5
9MA-38-1.1/2	38	2"-12	1.1/2"	60	22	135	2,5	97

Raccordo disponibile anche con tenuta elastomerica ISO 1179-2.
Per ordinare: sostituire nel codice il prefisso 9MA con 9MAE.

Straight fitting available also with elastomeric sealing ISO 1179-2.
To order: substitute the code prefix 9MA with 9MAE.