

A... = polipropilene / polypropylene\* MA... = polyamide / self-extinguishing RA... = gomma / rubber LA... = alluminio / aluminium  
 ...H = interno liscio / smooth inside (per ordine di collari tipo H, aggiungere H dopo il codice / to order clamps type H, please put the H at the end of the code)

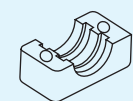

tipo normale  
interno sagomato  
normal model  
profiled inside

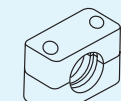

tipo normale  
interno sagomato  
normal model  
profiled inside

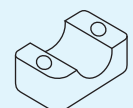

tipo H  
interno liscio  
H model  
smooth inside

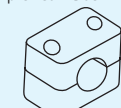

tipo H  
interno liscio  
H model  
smooth inside

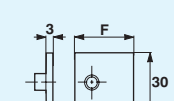

gruppo  
group **0**

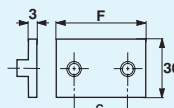

gruppo  
group **1 ÷ 6**

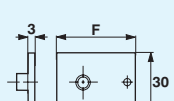

gruppo  
group **0**

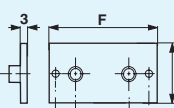

gruppo  
group **1 ÷ 6**

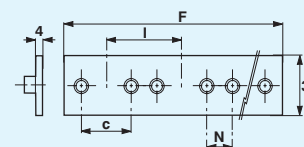
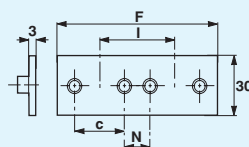

semi-collare clamp-half	coppia collari clamp body (2 halves)	piastra inferiore lower plate		piastra inferiore allungata prolonged lower plate			piastra inferiore doppia double lower plate					piastra inferiore multipla multiple lower plate				
		<b>APIN</b>		<b>APIA</b>			<b>APID</b>					<b>APIM</b>				
<b>A....S</b>	<b>A....C</b>	F mm	c mm	F mm	c mm	d mm	F mm	c mm	N mm	l mm	n° collari clamps	F mm	c mm	N mm	l mm	n° collari clamps
A <sub>0</sub> 06 S	A <sub>0</sub> 06 C	<b>APIN<sub>0</sub></b>		<b>APIA<sub>0</sub></b>			<b>APID<sub>0</sub></b>					<b>APIM<sub>0</sub></b>				
A <sub>0</sub> 08 S	A <sub>0</sub> 08 C															
A <sub>0</sub> 10 S	A <sub>0</sub> 10 C	31,5	-	46	-	-	63	-	-	30	2	315	-	-	30	10
A <sub>0</sub> 12 S	A <sub>0</sub> 12 C															
A <sub>1</sub> 06 S	A <sub>1</sub> 06 C	<b>APIN<sub>1</sub></b>		<b>APIA<sub>1</sub></b>			<b>APID<sub>1</sub></b>					<b>APIM<sub>1</sub></b>				
A <sub>1</sub> 6,4 S	A <sub>1</sub> 6,4 C															
A <sub>1</sub> 08 S	A <sub>1</sub> 08 C															
A <sub>1</sub> 9,5 S	A <sub>1</sub> 9,5 C	41	20	64	20	51	82	20	20	40	2	410	20	20	40	10
A <sub>1</sub> 10 S	A <sub>1</sub> 10 C															
A <sub>1</sub> 12 S	A <sub>1</sub> 12 C															
A <sub>2</sub> 12,7 S	A <sub>2</sub> 12,7	<b>APIN<sub>2</sub></b>		<b>APIA<sub>2</sub></b>			<b>APID<sub>2</sub></b>					<b>APIM<sub>2</sub></b>				
A <sub>2</sub> 1/4" S	A <sub>2</sub> 1/4" C															
A <sub>2</sub> 14 S	A <sub>2</sub> 14 C															
A <sub>2</sub> 15 S	A <sub>2</sub> 15 C															
A <sub>2</sub> 16 S	A <sub>2</sub> 16 C	46	26	70	26	56	92	26	18	44	2	460	26	18	44	10
A <sub>2</sub> 3/8" S	A <sub>2</sub> 3/8" C															
A <sub>2</sub> 18 S	A <sub>2</sub> 18 C															
A <sub>2</sub> 19 S	A <sub>2</sub> 19 C															
A <sub>3</sub> 19 S	A <sub>3</sub> 19 C	<b>APIN<sub>3</sub></b>		<b>APIA<sub>3</sub></b>			<b>APID<sub>3</sub></b>					<b>APIM<sub>3</sub></b>				
A <sub>3</sub> 20 S	A <sub>3</sub> 20 C															
A <sub>3</sub> 1/2" S	A <sub>3</sub> 1/2" C															
A <sub>3</sub> 22 S	A <sub>3</sub> 22 C	54	33	78	33	64	108	33	19	52	2	540	33	19	52	10
A <sub>3</sub> 25 S	A <sub>3</sub> 25 C															
A <sub>3</sub> 25,4 S	A <sub>3</sub> 25,4 C															
A <sub>4</sub> 3/4" S	A <sub>4</sub> 3/4" C	<b>APIN<sub>4</sub></b>		<b>APIA<sub>4</sub></b>			<b>APID<sub>4</sub></b>					<b>APIM<sub>4</sub></b>				
A <sub>4</sub> 28 S	A <sub>4</sub> 28 C															
A <sub>4</sub> 30 S	A <sub>4</sub> 30 C	61	40	86	40	71	122	40	20	60	2	305	40	20	60	5
A <sub>4</sub> 32 S	A <sub>4</sub> 32 C															
A <sub>5</sub> 32 S	A <sub>5</sub> 32 C	<b>APIN<sub>5</sub></b>		<b>APIA<sub>5</sub></b>			<b>APID<sub>5</sub></b>					<b>APIM<sub>5</sub></b>				
A <sub>5</sub> 1" S	A <sub>5</sub> 1" C															
A <sub>5</sub> 35 S	A <sub>5</sub> 35 C															
A <sub>5</sub> 38 S	A <sub>5</sub> 38 C															
A <sub>5</sub> 40 S	A <sub>5</sub> 40 C	73	52	97	52	83	146	52	23	75	2	365	52	23	75	5
A <sub>5</sub> 42 S	A <sub>5</sub> 42 C															
A <sub>5</sub> 1 1/4" S	A <sub>5</sub> 1 1/4" C															
A <sub>5</sub> 45 S	A <sub>5</sub> 45 C															
A <sub>6</sub> 44,5 S	A <sub>6</sub> 44,5 C	<b>APIN<sub>6</sub></b>		<b>APIA<sub>6</sub></b>			<b>APID<sub>6</sub></b>					<b>APIM<sub>6</sub></b>				
A <sub>6</sub> 1 1/2" S	A <sub>6</sub> 1 1/2" C															
A <sub>6</sub> 50,8 S	A <sub>6</sub> 50,8 C	89	66	112	66	100	178	66	24	90	2	445	66	24	90	5

\* La produzione standard è di colore verde, colore nero su richiesta.  
 Standard production in green, black color on request.