

Plugs

24° inner cones

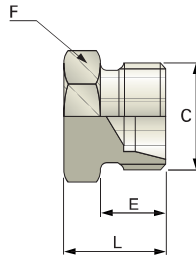

	PN	ØD	C		Bell code	E	F	L		
L	400	6	M12x1,5	8025L06 00	15-360/L6	10	12	14	0,008	
		8	M14x1,5	8025L08 00	15-360/L8	10	14	15	0,012	
		10	M16x1,5	8025L10 00	15-360/L10	11	17	16	0,018	
		12	M18x1,5	8025L12 00	15-360/L12	11	19	17	0,025	
		15	M22x1,5	8025L15 00	15-360/L15	12	24	18	0,041	
	315	18	M26x1,5	8025L18 00	15-360/L18	12	27	19	0,059	
		22	M30x2	8025L22 00	15-360/L22	14	32	21	0,087	
		28	M36x2	8025L28 00	15-360/L28	14	41	22	0,143	
		250	35	M45x2	8025L35 00	15-360/L35	16	46	25	0,209
			42	M52x2	8025L42 00	15-360/L42	16	55	27	0,308
S	630	6	M14x1,5	8025S06 00	15-360/S6	12	14	18	0,017	
		8	M16x1,5	8025S08 00	15-360/S8	12	17	20	0,027	
		10	M18x1,5	8025S10 00	15-360/S10	12	19	20	0,033	
		12	M20x1,5	8025S12 00	15-360/S12	12	22	22	0,049	
		14	M22x1,5	8025S14 00	15-360/S14	14	24	24	0,063	
	400	16	M24x1,5	8025S16 00	15-360/S16	14	27	24	0,077	
		20	M30x2	8025S20 00	15-360/S20	16	32	28	0,127	
		25	M36x2	8025S25 00	15-360/S25	18	41	32	0,230	
		30	M42x2	8025S30 00	15-360/S30	20	46	34	0,309	
		315	38	M52x2	8025S38 00	15-360/S38	22	55	39	0,510