

PLASTIC CAPS

| NOMINAL SIZE | | | | FEMALE DUST PLUG | | | | MALE DUST CAP | | | | COLOR | MATERIAL | |
|--------------|----|------|------------|------------------|-----|------|------------|---------------|------------|-----|------|------------|----------|-----|
| DNP | BG | ISO | COD. F | Dimensions | | | Weight (g) | COD. M | Dimensions | | | Weight (g) | | |
| | | | | D | L | D1 | | | D | L | D1 | | | |
| 06 | 1 | 6.3 | SPLT.06002 | 32.5 | 200 | 20 | 16 | SPLT.06003 | 26 | 200 | 20 | 13 | ● | PVC |
| 13 | 2 | 10 | SPLT.13002 | 37 | 200 | 26 | 21 | SPLT.13003 | 27.5 | 200 | 26 | 15 | ● | PVC |
| 20 | 3 | 12.5 | SPLT.20002 | 43 | 200 | 31.5 | 29 | SPLT.20003 | 35 | 200 | 31.5 | 26 | ● | PVC |
| 25 | 4 | 19 | SPLT.25002 | 53.5 | 265 | 35 | 51 | SPLT.25003 | 43 | 265 | 35 | 41 | ● | PVC |
| 30 | 5 | 25 | SPLT.30002 | 61 | 280 | 50 | 75 | SPLT.30003 | 51 | 270 | 50 | 60 | ● | PVC |

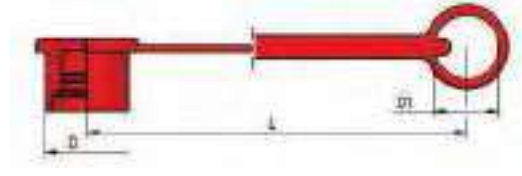
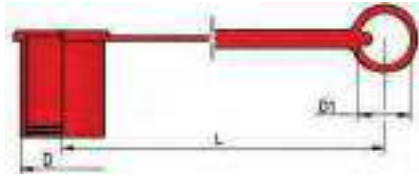

METAL CAPS

| NOMINAL SIZE | | | | FEMALE DUST PLUG | | | | MALE DUST CAP | | | | MATERIAL | |
|--------------|----|------|-------------|------------------|-----|------|------------|---------------|------------|-----|------|------------|----------|
| DNP | BG | ISO | COD. F | Dimensions | | | Weight (g) | COD. M | Dimensions | | | Weight (g) | |
| | | | | D | L | D1 | | | D | L | D1 | | |
| 06 | 1 | 6.3 | SPLT.06202 | 35 | 200 | 32 | 41 | SPLT.06203 | 25 | 200 | 32 | 28 | Aluminum |
| 13 | 2 | 10 | SPLT.13202 | 40 | 200 | 32 | 48 | SPLT.13203 | 30 | 200 | 32 | 39 | Aluminum |
| 20 | 3 | 12.5 | SPLT.20202 | 45 | 200 | 32 | 53 | SPLT.20203 | 32 | 200 | 32 | 40 | Aluminum |
| 25 | 4 | 19 | SPLT.25202 | 55 | 275 | 47.5 | 74 | SPLT.25203 | 40 | 275 | 47.5 | 66 | Aluminum |
| 30 | 5 | 25 | SPLT.30202 | 65 | 275 | 47.5 | 126 | SPLT.30203 | 45 | 275 | 47.5 | 71 | Aluminum |
| 35 | 6 | 31.5 | SPLT.35202* | - | - | - | - | SPLT.35203* | - | - | - | - | Aluminum |
| 39 | 7 | 40 | SPLT.39202 | 90 | 275 | 47.5 | 207 | SPLT.39203 | 68 | 275 | 47.5 | 155 | Aluminum |
| 50 | 8 | 50 | SPLT.50202 | 114 | 275 | 47.5 | 360 | See PLK4 DN50 | | | | | Aluminum |

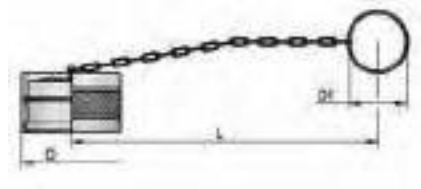
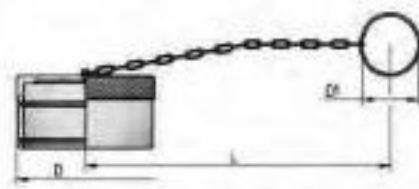

*REALIZZATI SU RICHIESTA DEL CLIENTE
 *AVAILABLE ON REQUEST
 *AUF ANFRAGE LIEFERBAR
 *DISPONIBLES SUR DEMANDE

AUTOMATIC CAPS

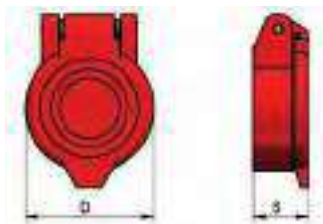

| NOMINAL SIZE | | | | AUTOMATIC FEMALE CAP | | | COLOR | MATERIAL |
|--------------|----|------|------------|----------------------|------|------------|-------|----------|
| DNP | BG | ISO | COD. F | Dimensions | | Weight (g) | | |
| | | | | D | S | | | |
| 13 | 2 | 10 | SPLT.13302 | 38 | 16.8 | 17 | ● | Nylon |
| 13 | 2 | 10 | SPLT.13342 | 38 | 16.8 | 17 | ● | Nylon |
| 20 | 3 | 12.5 | SPPV.13302 | 46 | 18.4 | 24 | ● | Nylon |
| 20 | 3 | 12.5 | SPPV.13312 | 46 | 18.4 | 24 | ● | Nylon |
| 20 | 3 | 12.5 | SPPV.13322 | 46 | 18.4 | 24 | ● | Nylon |
| 20 | 3 | 12.5 | SPPV.13332 | 46 | 18.4 | 24 | ● | Nylon |
| 20 | 3 | 12.5 | SPPV.13342 | 46 | 18.4 | 24 | ● | Nylon |

SPARE PARTS

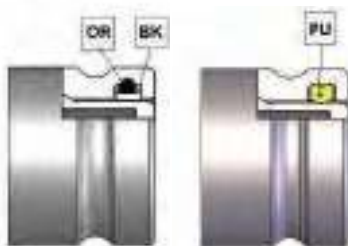

| NOMINAL SIZE | | | MALE GASKET | MALE GASKET |
|--------------|----|------|-------------|-------------|
| DNP | BG | ISO | OR (NBR*) | BK (PTFE) |
| 06 | 1 | 6.3 | PLT.006.120 | PLT.006.130 |
| 13 | 2 | 10 | PLT.013.120 | PLT.013.130 |
| 20 | 3 | 12.5 | PLT.019.120 | PLT.019.130 |
| 25 | 4 | 19 | PLT.025.120 | PLT.025.130 |
| 30 | 5 | 25 | PLT.031.120 | PLT.031.130 |
| 35 | 6 | 31.5 | PLS.025.120 | PLT.035.130 |
| 39 | 7 | 38 | PLT.039.120 | PLT.039.130 |
| 50 | 8 | 51 | PLK.050.120 | PLK.050.130 |

*AL CODICE DELLA GUARNIZIONE IN NBR AGGIUNGERE 'E' PER EPDM O 'V' PER VITON
 *TO THE NBR GASKET CODE ADD 'E' FOR EPDM OR 'V' FOR VITON
 *ZU DER ARTIKELNR. DER NBR DICHTUNG GEBEN SIE 'E' FUER EPDM ODER 'V' FUER VITON AN
 *AU CODE DU JOINT EN NBR JOINDRE 'E' POUR EPDM OU 'V' POUR VITON