

VVS



Screw to connect couplings for high pressure applications, Faster interchange

Screw-on couplings commonly used for applications characterized by very high working pressures and peaks. Heavy duty internal components guarantee the maximum safety and reliability. Faster proprietary profile. Interchangeable with Faster VV series.



Applications

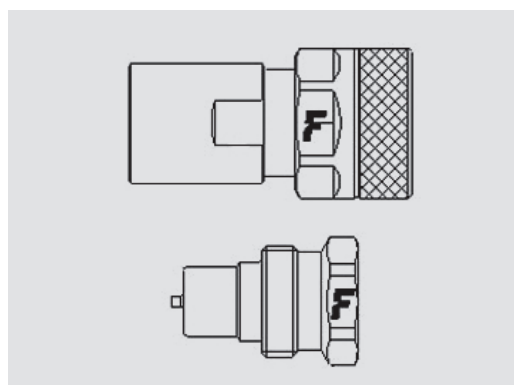

Technical Specifications

dash	Size		Working Pressure (MPa)	Flow Rate (l/min)	Spillage (ml)	Force to Connect (N)	Burst pressure (MPa)		
	mm	inch					Male	Female	Male + Female
04	6,3	1/4"	80	8	0,4	0	240	240	250
06	10	3/8"	80	18	0,8	0	340	350	240
08	12,5	1/2"	70	40	1,3	0	210	210	210
12	20	3/4"	70	55	1,8	0	240	210	230
16	25	1"	63	100	8	0	190	240	190
20	31,5	1-1/4"	60	140	15	0	180	180	200
24	37,5	1-1/2"	40	300	38	0	120	150	150
32	50	2"	35	1000	46	0	130	130	105

Material	Steel
Seals	NBR
Working temperatures	- 25 °C to + 125 °C
Surface treatment	MATE 500 (CrIII)
Series Interchange	FASTER
Valve Type	Poppet
Connection	Screw to Connect
Disconnection	Unscrew to Disconnect
Connection Under Pressure	Allowed Residual

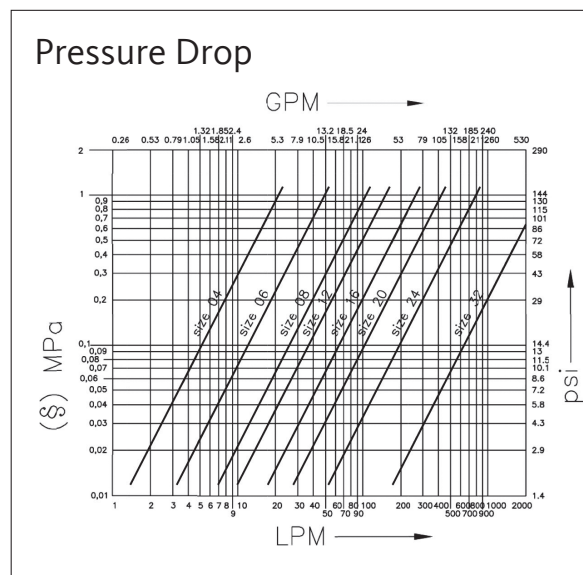

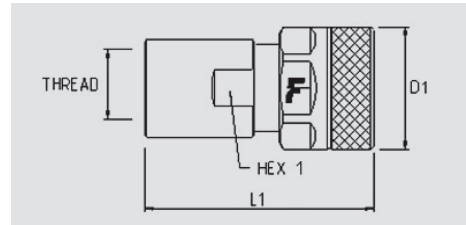

Size		Thread details			FEMALE						
inch	mm	Thread Type	Standard	Thread	Part Number	L (L1 + Thread)		D1		HEX1	
						mm	inch	mm	inch	mm	inch
1/4"	6,3	F BSPP	ISO 1179-1	BSPP 1/4 FEMALE	VVS 14 GAS F	68	2,7	30	1,2	22	0,9
1/4"	6,3	F NPTF	ANSI B1.20.3	NPTF 1/4 FEMALE	VVS 14 NPT F	68	2,7	30	1,2	22	0,9
3/8"	10	F BSPP	ISO 1179-1	BSPP 3/8 FEMALE	VVS 38 GAS F	76	3	40	1,6	30	1,2
3/8"	10	F NPTF	ANSI B1.20.3	NPTF 3/8 FEMALE	VVS 38 NPT F	76	3	40	1,6	30	1,2
1/2"	12,5	F BSPP	ISO 1179-1	BSPP 1/2 FEMALE	VVS 12 GAS F	87	3,4	45	1,8	34	1,3
1/2"	12,5	F NPTF	ANSI B1.20.3	NPTF 1/2 FEMALE	VVS 12 NPT F	87	3,4	45	1,8	34	1,3
3/4"	20	F BSPP	ISO 1179-1	BSPP 3/4 FEMALE	VVS 34 GAS F	106	4,2	55	2,2	41	1,6
3/4"	20	F NPTF	ANSI B1.20.3	NPTF 3/4 FEMALE	VVS 34 NPT F	106	4,2	55	2,2	41	1,6
1"	25	F BSPP	ISO 1179-1	BSPP 1 FEMALE	VVS 1 GAS F	124	4,9	60	2,4	50	2
1"	25	F NPTF	ANSI B1.20.3	NPTF 1 FEMALE	VVS 1 NPT F	124	4,9	60	2,4	50	2
1-1/4"	31,5	F BSPP	ISO 1179-1	BSPP 1-1/4 FEMALE	VVS114 GAS F	152	6	80	3,2	65	2,6
1-1/4"	31,5	F NPTF	ANSI B1.20.3	NPTF 1-1/4 FEMALE	VVS114 NPT F	152	6	80	3,2	65	2,6
1-1/2"	37,5	F BSPP	ISO 1179-1	BSPP 1-1/2 FEMALE	VVS112 GAS F	172	6,8	98	3,9	75	3
1-1/2"	37,5	F NPTF	ANSI B1.20.3	NPTF 1-1/2 FEMALE	VVS112 NPT F	172	6,8	98	3,9	75	3
2"	50	F BSPP	ISO 1179-1	BSPP 2 FEMALE	VVS 2 GAS F	206	8,1	129	5,1	100	3,9
2"	50	F NPTF	ANSI B1.20.3	NPTF 2 FEMALE	VVS 2 NPT F	207	8,2	129	5,1	100	3,9

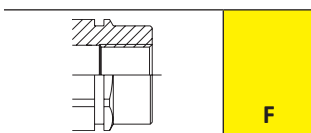

VVS

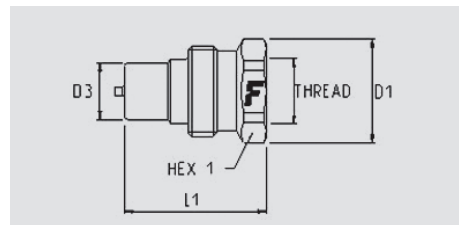

Size		Thread details			MALE									
inch	mm	Thread Type	Standard	Thread	Part Number	L (L1 + Thread)		D1		D3		HEX1		
						mm	inch	mm	inch	mm	inch	mm	inch	
1/4"	6,3	F BSPP	ISO 1179-1	BSPP 1/4 FEMALE	VVS 14 GAS M	43	1,7	28	1,1	14,1	0,6	25	1	
1/4"	6,3	F NPTF	ANSI B1.20.3	NPTF 1/4 FEMALE	VVS 14 NPT M	48	1,9	28	1,1	14,1	0,6	32	1,3	
3/8"	10	F BSPP	ISO 1179-1	BSPP 3/8 FEMALE	VVS 38 GAS M	48	1,9	35	1,4	18,9	0,7	30	1,2	
3/8"	10	F NPTF	ANSI B1.20.3	NPTF 3/8 FEMALE	VVS 38 NPT M	48	1,9	35	1,4	18,9	0,7	30	1,2	
1/2"	12,5	F BSPP	ISO 1179-1	BSPP 1/2 FEMALE	VVS 12 GAS M	53	2,1	38	1,5	20,5	0,8	34	1,3	
1/2"	12,5	F NPTF	ANSI B1.20.3	NPTF 1/2 FEMALE	VVS 12 NPT M	53	2,1	38	1,5	20,5	0,8	34	1,3	
3/4"	20	F BSPP	ISO 1179-1	BSPP 3/4 FEMALE	VVS 34 GAS M	63	2,5	50	2	27,9	1,1	46	1,8	
3/4"	20	F NPTF	ANSI B1.20.3	NPTF 3/4 FEMALE	VVS 34 NPT M	63	2,5	50	2	27,9	1,1	45	1,8	
1"	25	F BSPP	ISO 1179-1	BSPP 1 FEMALE	VVS 1 GAS M	72	2,8	55	2,2	31,3	1,2	50	2	
1"	25	F NPTF	ANSI B1.20.3	NPTF 1 FEMALE	VVS 1 NPT M	72	2,8	55	2,2	31,3	1,2	50	2	
1-1/4"	31,5	F BSPP	ISO 1179-1	BSPP 1-1/4 FEMALE	VVS114 GAS M	86	3,4	70	2,8	43,9	1,7	65	2,6	
1-1/4"	31,5	F NPTF	ANSI B1.20.3	NPTF 1-1/4 FEMALE	VVS114 NPT M	86	3,4	70	2,8	43,9	1,7	65	2,6	
1-1/2"	37,5	F BSPP	ISO 1179-1	BSPP 1-1/2 FEMALE	VVS112 GAS M	95	3,7	84	3,3	53,4	2,1	80	3,2	
1-1/2"	37,5	F NPTF	ANSI B1.20.3	NPTF 1-1/2 FEMALE	VVS112 NPT M	95	3,7	84	3,3	53,4	2,1	80	3,2	
2"	50	F BSPP	ISO 1179-1	BSPP 2 FEMALE	VVS 2 GAS M	118	4,7	115	4,5	81,9	3,2	110	4,3	
2"	50	F NPTF	ANSI B1.20.3	NPTF 2 FEMALE	VVS 2 NPT M	118	4,7	115	4,5	81,9	3,2	110	4,3	

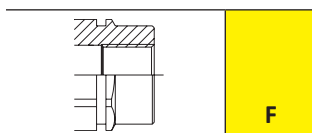

VVS accessories

Aluminium dust caps



Plugs suitable for FEMALE



Caps suitable for MALE

Size			Plug Details		Size			Cap Details	
inch	mm	dash	Part number	Colour	inch	mm	dash	Part number	Colour
1/4"	6,3	04	TMV 14 S		1/4"	6,3	04	TFP 14	
1/2"	12,5	08	TMV 12 S		1/4"	6,3	04	TFV 14 S	
1/2"	12,5	08	TMVM 12 SR	red strap	1/2"	12,5	08	TFV 12 S	
3/4"	20	12	TMV 34 S		1/2"	12,5	08	TFVM 12 SR	red strap
1-1/4"	31,5	20	TMV114 S		3/4"	20	12	TFV 34 S	
2"	50	32	TMV 2 S		1"	25	16	TFV 1 S	
1-1/2"	37,5	24	TMV112 S		1-1/4"	31,5	20	TFV114 S	
					1-1/2"	37,5	24	TFV112 S	
					2"	50	32	TFV 2 S	

Stainless steel dust caps



Plugs suitable for FEMALE



Caps suitable for MALE

Size			Plug Details		Size			Cap Details	
inch	mm	dash	Part number	Colour	inch	mm	dash	Part number	Colour
1/4"	6,3	04	TMV 14 SS		1/4"	6,3	04	TFV 14 SS	
3/8"	10	06	TMV 38 SS		3/8"	10	06	TFV 38 SS	
1/2"	12,5	08	TMV 12 SS		1/2"	12,5	08	TFV 12 SS	
3/4"	20	12	TMV 34 SS		3/4"	20	12	TFV 34 SS	
1"	25	16	TMV 1 SS		1"	25	16	TFV 1 SS	
1-1/4"	31,5	20	TMV114 SS		1-1/4"	31,5	20	TFV114 SS	
1-1/2"	37,5	24	TMV112 SS		1-1/2"	37,5	24	TFV112 SS	
2"	50	32	TMV 2 SS		2"	50	32	TFV 2 SS	

Seal Kits



For Female

Size			Seal Details	
inch	mm	dash	Material	Part Number
1/4"	6,3	04	NBR; PTFE	SK NV 14
3/8"	10	06	NBR; PTFE	SK NV 38
1/2"	12,5	08	NBR; PTFE	SK NV 12
3/4"	20	12	NBR; PTFE	SK NV 34
1"	25	16	NBR; PTFE	SK NV 1
1-1/4"	31,5	20	NBR; PTFE	SK VVS 114
1-1/2"	37,5	24	NBR; PTFE	SK VVS 112
2"	50	32	NBR; PTFE	SK VVS 2

Every seals kit is composed of 5 or 10 pcs.