

## Rubrik 8.96

### UNF - Standard

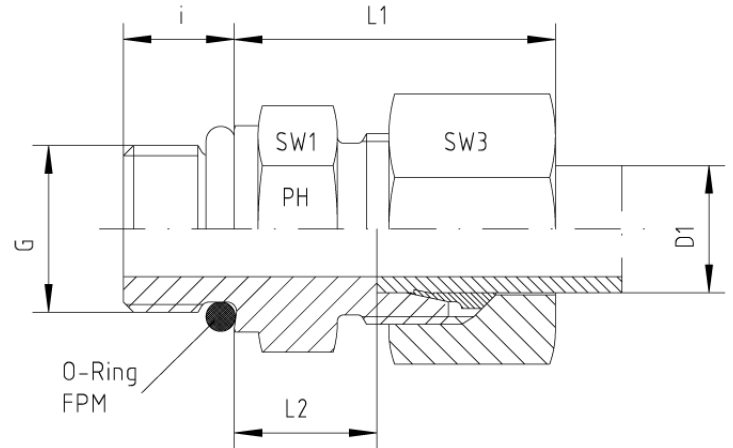
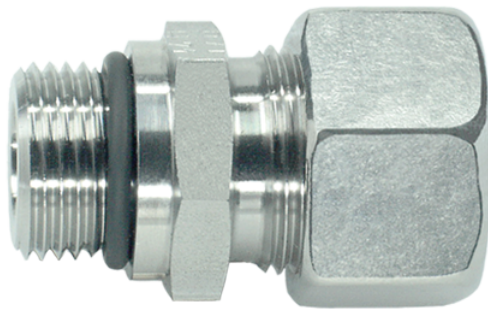

Male Stud Couplings S-Series Thread: UNF (ASA B 1.1 - 1960) Sealing by O-ring in Thread Undercut - SAE J 514 Note: A special part shape must be machined. Other jump sizes on request!

| Pressure | Tube O.D. | Thread | Approx. Dimensions |    |   |     |     | O-ring | Order-Code |
|----------|-----------|--------|--------------------|----|---|-----|-----|--------|------------|
|          |           |        | L1                 | L2 | i | SW1 | SW3 |        |            |
| PN       | D1        | G      | L1                 | L2 | i | SW1 | SW3 |        |            |

#### Series S

|     |    |               |      |      |      |    |    |              |                    |
|-----|----|---------------|------|------|------|----|----|--------------|--------------------|
| 630 | 6  | 7/16"-20 UNF  | 28,0 | 13,0 | 9,2  | 17 | 17 | 8,92 x 1,83  | GE-S-06-7/16"-UNF  |
| 630 | 6  | 9/16"-18 UNF  | 29,0 | 13,0 | 10,0 | 19 | 17 | 11,90 x 1,98 | GE-S-06-9/16"-UNF  |
| 630 | 8  | 7/16"-20 UNF  | 30,0 | 15,0 | 9,2  | 17 | 19 | 8,92 x 1,83  | GE-S-08-7/16"-UNF  |
| 630 | 8  | 1/2"-20 UNF   | 30,0 | 15,0 | 9,2  | 17 | 19 | 10,52 x 1,83 | GE-S-08-1/2"-UNF   |
| 630 | 8  | 9/16"-18 UNF  | 30,0 | 13,0 | 10,0 | 19 | 19 | 11,90 x 1,98 | GE-S-08-9/16"-UNF  |
| 630 | 10 | 7/16"-20 UNF  | 41,0 | 13,5 | 9,2  | 19 | 22 | 8,92 x 1,83  | GE-S-10-7/16"-UNF  |
| 630 | 10 | 9/16"-18 UNF  | 31,0 | 15,5 | 10,0 | 19 | 22 | 11,90 x 1,98 | GE-S-10-9/16"-UNF  |
| 630 | 10 | 3/4"-16 UNF   | 31,0 | 15,0 | 11,2 | 24 | 22 | 16,36 x 2,20 | GE-S-10-3/4"-UNF   |
| 630 | 12 | 9/16"-18 UNF  | 33,5 | 14,5 | 10,0 | 22 | 24 | 11,90 x 1,98 | GE-S-12-9/16"-UNF  |
| 630 | 12 | 3/4"-16 UNF   | 33,5 | 17,5 | 11,2 | 24 | 24 | 16,36 x 2,20 | GE-S-12-3/4"-UNF   |
| 630 | 12 | 7/8"-14 UNF   | 32,5 | 14,8 | 12,7 | 27 | 24 | 19,18 x 2,46 | GE-S-12-7/8"-UNF   |
| 630 | 14 | 9/16"-18 UNF  | 37,0 | 19,0 | 10,0 | 24 | 27 | 11,90 x 1,98 | GE-S-14-9/16"-UNF  |
| 630 | 14 | 3/4"-16 UNF   | 37,0 | 19,0 | 11,2 | 24 | 27 | 16,36 x 2,20 | GE-S-14-3/4"-UNF   |
| 400 | 16 | 9/16"-18 UNF  | 51,0 | 19,5 | 10,0 | 27 | 30 | 11,90 x 1,98 | GE-S-16-9/16"-UNF  |
| 400 | 16 | 3/4"-16 UNF   | 37,0 | 18,5 | 11,2 | 27 | 30 | 16,36 x 2,20 | GE-S-16-3/4"-UNF   |
| 400 | 16 | 7/8"-14 UNF   | 33,5 | 15,5 | 14,0 | 30 | 30 | 19,18 x 2,46 | GE-S-16-7/8"-UNF   |
| 400 | 16 | 1 1/16"-12 UN | 37,0 | 18,5 | 15,0 | 32 | 30 | 23,47 x 2,95 | GE-S-16-1 1/16"-UN |
| 400 | 20 | 3/4"-16 UNF   | 45,0 | 20,5 | 11,2 | 32 | 36 | 16,36 x 2,20 | GE-S-20-3/4"-UNF   |

|     |    |               |      |      |      |    |    |              |                    |
|-----|----|---------------|------|------|------|----|----|--------------|--------------------|
| 400 | 20 | 7/8"-14 UNF   | 46,5 | 20,5 | 12,7 | 32 | 36 | 19,18 x 2,46 | GE-S-20-7/8"-UNF   |
| 400 | 20 | 1 1/16"-12 UN | 45,0 | 20,5 | 15,0 | 32 | 36 | 23,47 x 2,95 | GE-S-20-1 1/16"-UN |
| 400 | 20 | 1 5/16"-12 UN | 45,0 | 22,5 | 15,0 | 41 | 36 | 29,74 x 2,95 | GE-S-20-1 5/16"-UN |
| 400 | 25 | 1 1/16"-12 UN | 47,0 | 23,0 | 15,0 | 41 | 46 | 23,47 x 2,95 | GE-S-25-1 1/16"-UN |
| 400 | 25 | 1 5/16"-12 UN | 47,0 | 23,0 | 15,0 | 41 | 46 | 29,74 x 2,95 | GE-S-25-1 5/16"-UN |
| 400 | 30 | 1 1/16"-12 UN | 50,0 | 23,5 | 15,0 | 46 | 50 | 23,47 x 2,95 | GE-S-30-1 1/16"-UN |
| 400 | 30 | 1 5/16"-12 UN | 50,0 | 23,5 | 15,0 | 46 | 50 | 29,74 x 2,95 | GE-S-30-1 5/16"-UN |
| 400 | 30 | 1 5/8"-12 UN  | 50,0 | 23,5 | 15,0 | 50 | 50 | 37,46 x 3,00 | GE-S-30-1 5/8"-UN  |
| 315 | 38 | 1 5/16"-12 UN | 57,0 | 26,0 | 15,0 | 55 | 60 | 29,74 x 2,95 | GE-S-38-1 5/16"-UN |
| 315 | 38 | 1 5/8"-12 UN  | 57,0 | 26,0 | 15,0 | 55 | 60 | 37,46 x 3,00 | GE-S-38-1 5/8"-UN  |
| 315 | 38 | 1 7/8"-12 UN  | 57,0 | 26,0 | 15,0 | 55 | 60 | 43,69 x 3,00 | GE-S-38-1 7/8"-UN  |