

Rubrik 9.7

Swivel Unions - GV - DKO - DKO

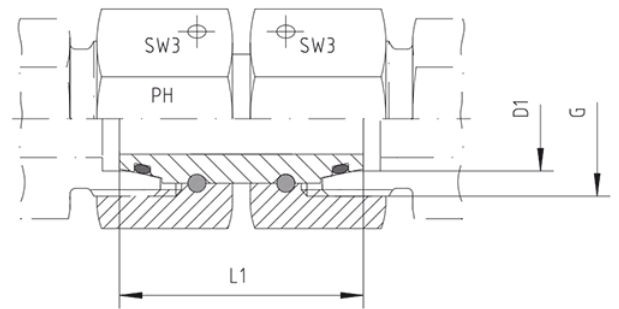
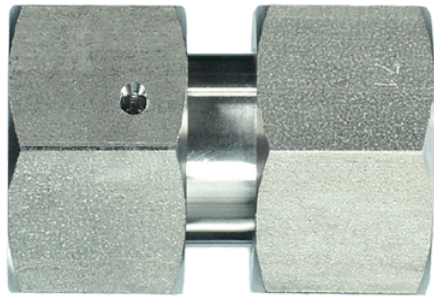

With Taper and O-ring - FKM For Type of Port End W DIN 3861

| Pressure | Tube O.D. | Thread | Approx. Dimensions | | Order-Code |
|----------|-----------|--------|--------------------|-----|------------|
| | | | L1 | SW3 | |
| PN | D1 | G | | | |

Series L

| | | | | | |
|-----|----|------------|------|----|------------|
| 500 | 6 | M 12 x 1,5 | 33,0 | 14 | GV-DKOL-06 |
| 500 | 8 | M 14 x 1,5 | 33,7 | 17 | GV-DKOL-08 |
| 500 | 10 | M 16 x 1,5 | 34,5 | 19 | GV-DKOL-10 |
| 400 | 12 | M 18 x 1,5 | 35,0 | 22 | GV-DKOL-12 |
| 400 | 15 | M 22 x 1,5 | 39,0 | 27 | GV-DKOL-15 |
| 400 | 18 | M 26 x 1,5 | 38,0 | 32 | GV-DKOL-18 |
| 250 | 22 | M 30 x 2 | 43,0 | 36 | GV-DKOL-22 |
| 250 | 28 | M 36 x 2 | 46,0 | 41 | GV-DKOL-28 |
| 250 | 35 | M 45 x 2 | 47,0 | 50 | GV-DKOL-35 |
| 250 | 42 | M 52 x 2 | 52,0 | 60 | GV-DKOL-42 |

Series S

| | | | | | |
|-----|----|------------|------|----|------------|
| 800 | 6 | M 14 x 1,5 | 33,0 | 17 | GV-DKOS-06 |
| 800 | 8 | M 16 x 1,5 | 36,0 | 19 | GV-DKOS-08 |
| 800 | 10 | M 18 x 1,5 | 36,0 | 22 | GV-DKOS-10 |
| 630 | 12 | M 20 x 1,5 | 38,0 | 24 | GV-DKOS-12 |
| 630 | 14 | M 22 x 1,5 | 38,0 | 27 | GV-DKOS-14 |
| 630 | 16 | M 24 x 1,5 | 39,0 | 30 | GV-DKOS-16 |



| | | | | | |
|-----|----|----------|------|----|------------|
| 420 | 20 | M 30 x 2 | 46,5 | 36 | GV-DKOS-20 |
| 420 | 25 | M 36 x 2 | 47,5 | 46 | GV-DKOS-25 |
| 420 | 30 | M 42 x 2 | 52,0 | 50 | GV-DKOS-30 |
| 420 | 38 | M 52 x 2 | 52,5 | 60 | GV-DKOS-38 |