

Rubrik 9.47

BSP - Parallel

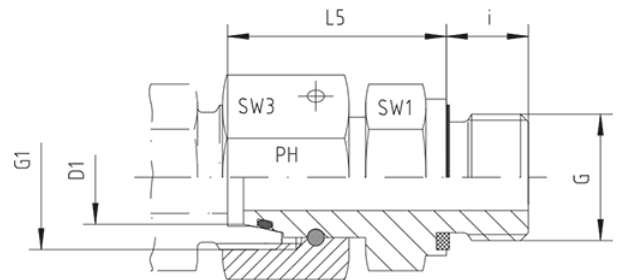
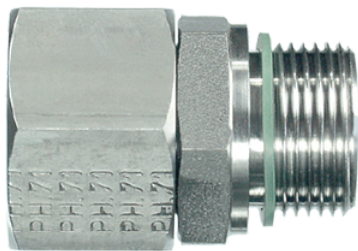

With Taper and O-ring - FPM

For Type of Port End W DIN 3861

Thread: BSP - Parallel

wd = Sealing by an Elastomer Profiled Ring - FPM

Pressure	Tube O.D.	Thread		Approx. Dimensions				Order-Code	
		PN	D1	G	G1	L5	i		SW1
Series L									
500	6		G 1/8"	M 12 x 1,5	24,5	8	14	14	EGE-DKOL-06-G 1/8"-wd
500	6		G 1/4"	M 12 x 1,5	27,0	12	19	14	EGE-DKOL-06-G 1/4"-wd
400	6		G 3/8"	M 12 x 1,5	28,0	12	22	14	EGE-DKOL-06-G 3/8"-wd
500	8		G 1/8"	M 14 x 1,5	25,5	8	14	17	EGE-DKOL-08-G 1/8"-wd
500	8		G 1/4"	M 14 x 1,5	29,5	12	19	17	EGE-DKOL-08-G 1/4"-wd
400	8		G 3/8"	M 14 x 1,5	29,5	12	22	17	EGE-DKOL-08-G 3/8"-wd
400	8		G 1/2"	M 14 x 1,5	29,0	14	27	17	EGE-DKOL-08-G 1/2"-wd
500	10		G 1/8"	M 16 x 1,5	25,5	8	14	19	EGE-DKOL-10-G 1/8"-wd
500	10		G 1/4"	M 16 x 1,5	27,5	12	19	19	EGE-DKOL-10-G 1/4"-wd
400	10		G 1/2"	M 16 x 1,5	30,0	14	27	19	EGE-DKOL-10-G 1/2"-wd
400	10		G 3/8"	M 16 x 1,5	30,0	12	22	19	EGE-DKOL-10-G 3/8"-wd
400	12		G 1/8"	M 18 x 1,5	26,0	8	17	22	EGE-DKOL-12-G 1/8"-wd
400	12		G 1/4"	M 18 x 1,5	28,0	12	19	22	EGE-DKOL-12-G 1/4"-wd
400	12		G 3/8"	M 18 x 1,5	32,0	12	22	22	EGE-DKOL-12-G 3/8"-wd
400	12		G 1/2"	M 18 x 1,5	34,5	14	27	22	EGE-DKOL-12-G 1/2"-wd
400	15		G 3/8"	M 22 x 1,5	35,0	12	24	27	EGE-DKOL-15-G 3/8"-wd

400	15	G 1/2"	M 22 x 1,5	35,0	14	27	27	EGE-DKOL-15-G 1/2"-wd
250	15	G 3/4"	M 22 x 1,5	48,0	16	32	27	EGE-DKOL-15-G 3/4"-wd
400	18	G 3/8"	M 26 x 1,5	34,0	12	24	32	EGE-DKOL-18-G 3/8"-wd
400	18	G 1/2"	M 26 x 1,5	31,5	14	27	32	EGE-DKOL-18-G 1/2"-wd
315	18	G 3/4"	M 26 x 1,5	33,0	16	32	32	EGE-DKOL-18-G 3/4"-wd
250	22	G 1/2"	M 30 x 2	32,0	14	27	36	EGE-DKOL-22-G 1/2"-wd
250	22	G 3/4"	M 30 x 2	32,5	16	32	36	EGE-DKOL-22-G 3/4"-wd
250	22	G 1"	M 30 x 2	33,0	18	41	36	EGE-DKOL-22-G 1"-wd
250	28	G 3/4"	M 36 x 2	35,0	16	32	41	EGE-DKOL-28-G 3/4"-wd
250	28	G 1"	M 36 x 2	35,0	18	41	41	EGE-DKOL-28-G 1"-wd
250	35	G 1 1/4"	M 45 x 2	42,5	20	50	50	EGE-DKOL-35-G 1 1/4"-wd
250	42	G 1 1/4"	M 52 x 2	40,5	20	50	60	EGE-DKOL-42-G 1 1/4"-wd
250	42	G 1 1/2"	M 52 x 2	46,5	22	55	60	EGE-DKOL-42-G 1 1/2"-wd

Series S

800	6	G 1/4"	M 14 x 1,5	27,0	12	19	17	EGE-DKOS-06-G 1/4"-wd
800	8	G 1/4"	M 16 x 1,5	29,5	12	19	19	EGE-DKOS-08-G 1/4"-wd
800	8	G 3/8"	M 16 x 1,5	29,5	12	22	19	EGE-DKOS-08-G 3/8"-wd
800	10	G 3/8"	M 18 x 1,5	32,0	12	22	22	EGE-DKOS-10-G 3/8"-wd
800	10	G 1/4"	M 18 x 1,5	27,5	12	19	22	EGE-DKOS-10-G 1/4"-wd
630	10	G 1/2"	M 18 x 1,5	32,0	14	27	22	EGE-DKOS-10-G 1/2"-wd
630	12	G 1/4"	M 20 x 1,5	42,0	12	19	24	EGE-DKOS-12-G 1/4"-wd
630	12	G 3/8"	M 20 x 1,5	34,0	12	22	24	EGE-DKOS-12-G 3/8"-wd
630	12	G 1/2"	M 20 x 1,5	34,5	14	27	24	EGE-DKOS-12-G 1/2"-wd
630	14	G 1/2"	M 22 x 1,5	36,5	14	27	27	EGE-DKOS-14-G 1/2"-wd
630	16	G 3/8"	M 24 x 1,5	37,0	12	24	30	EGE-DKOS-16-G 3/8"-wd
630	16	G 1/2"	M 24 x 1,5	37,0	14	27	30	EGE-DKOS-16-G 1/2"-wd
420	16	G 3/4"	M 24 x 1,5	39,0	16	32	30	EGE-DKOS-16-G 3/4"-wd
420	20	G 1/2"	M 30 x 2	38,0	14	27	36	EGE-DKOS-20-G 1/2"-wd
420	20	G 3/4"	M 30 x 2	43,0	16	32	36	EGE-DKOS-20-G 3/4"-wd
420	20	G 1"	M 30 x 2	55,0	18	41	36	EGE-DKOS-20-G 1"-wd
420	25	G 3/4"	M 36 x 2	58,0	16	32	46	EGE-DKOS-25-G 3/4"-wd
420	25	G 1"	M 36 x 2	48,0	18	41	46	EGE-DKOS-25-G 1"-wd
420	30	G 1"	M 42 x 2	46,0	18	41	50	EGE-DKOS-30-G 1"-wd
420	30	G 1 1/4"	M 42 x 2	51,0	20	50	50	EGE-DKOS-30-G 1 1/4"-wd
420	38	G 1 1/2"	M 52 x 2	60,0	22	55	60	EGE-DKOS-38-G 1 1/2"-wd