

## Rubrik 5.25

### BSP - Male - BSP - Taper - Male

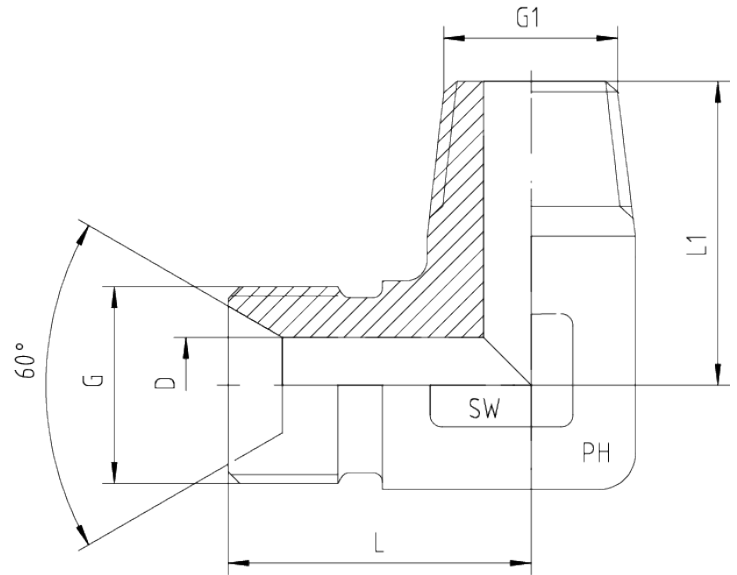
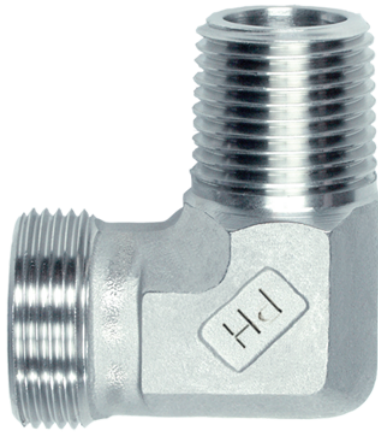

BSP - Male with 60°-Cone BSP - Taper - Male

Pressure	Thread		Approx. Dimensions				Order-Code	
	PN	G = BSP zyl.	G1 = keg.	L	L1	D		SW
400		1/8"-28	1/8"-28	20,0	20,0	4,0	12	1350500-02
400		1/4"-19	1/4"-19	24,5	26,0	6,0	14	1350500-04
400		3/8"-19	3/8"-19	25,5	25,5	8,0	17	1350500-06
400		1/2"-14	1/2"-14	29,5	35,0	11,0	19	1350500-08
400		3/4"-14	3/4"-14	37,0	37,0	16,0	27	1350500-12
400		1"-11	1"-11	43,0	43,0	22,0	36	1350500-16
200		1 1/4"-11	1 1/4"-11	51,0	51,0	28,5	41	1350500-20
200		1 1/2"-11	1 1/2"-11	59,0	63,0	33,5	50	1350500-24
100		2"-11	2"-11	77,5	77,5	45,0	65	1350500-32