

Rubrik 5.59

BSP-60°-Coned Plug - Parallel with Outside Hexagon

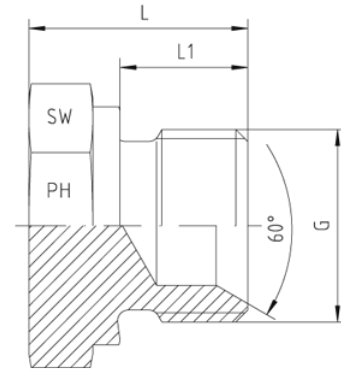

With Hexagon 60°-Cone and Sealing Shoulder Form B

Pressure	Thread	Approx. Dimensions			Order-Code
		L	L1	SW	
PN	G = BSP				
400	1/8"-28	14,0	8	14	1050514-02
400	1/4"-19	17,0	10	19	1050514-04
400	3/8"-19	20,5	12	22	1050514-06
400	1/2"-14	24,0	14	27	1050514-08
400	5/8"-14	24,0	14	30	1050514-10
400	3/4"-14	27,0	16	32	1050514-12
400	1"-11	31,0	18	41	1050514-16
200	1 1/4"-11	33,0	20	50	1050514-20
200	1 1/2"-11	36,0	22	55	1050514-24
100	2"-11	36,0	22	70	1050514-32