

45° ELBOW JIS GAS MALE 60° CONE / BSPT MALE

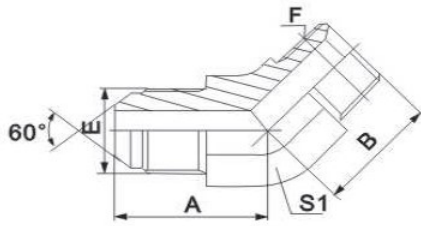

| PART NO. | THREAD | | DIMENSIONS | | | |
|----------|------------|------------|------------|------|----|--|
| | E | F | A | B | S1 | |
| | G1/8"X28 | R1/8"X28 | 19 | 17 | 11 | |
| | G1/8"X28 | R1/4"X19 | 19.8 | 21 | 14 | |
| | G1/4"X19 | R1/4"X19 | 24 | 21 | 14 | |
| | G1/4"X19 | R1/8"X28 | 24.5 | 17.5 | 14 | |
| | G1/4"X19 | R3/8"X19 | 24.5 | 23 | 16 | |
| | G1/4"X19 | R1/2"X14 | 26.5 | 29.5 | 22 | |
| | G3/8"X19 | R3/8"X19 | 26 | 23 | 16 | |
| | G3/8"X19 | R1/4"X19 | 26 | 21 | 16 | |
| | G3/8"X19 | R1/2"X14 | 28.5 | 29.5 | 22 | |
| | G1/2"X14 | R1/2"X14 | 31 | 29.5 | 22 | |
| | G1/2"X14 | R3/8"X19 | 30.5 | 25 | 22 | |
| | G3/4"X14 | R3/4"X14 | 34.5 | 30.5 | 27 | |
| | G3/4"X14 | R1/2"X14 | 34 | 30 | 27 | |
| | G1"X11 | R1"X11 | 37.5 | 38 | 33 | |
| | G1"X11 | R3/4"X14 | 37.5 | 32 | 33 | |
| | G1.1/4"X11 | R1.1/4"X11 | 44.5 | 43 | 41 | |
| | G1.1/2"X11 | R1.1/2"X11 | 47.5 | 47 | 48 | |
| | G2"X11 | R2"X11 | 54 | 53 | 63 | |

90° ELBOW JIS GAS MALE 60° CONE / BSPT MALE

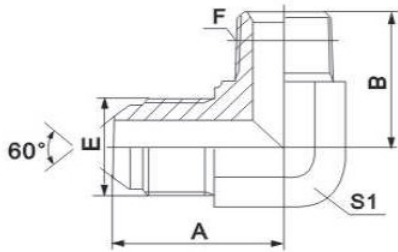

| PART NO. | THREAD | | DIMENSIONS | | | |
|----------|------------|------------|------------|------|----|--|
| | E | F | A | B | S1 | |
| | G1/8"X28 | R1/8"X28 | 21.8 | 21 | 11 | |
| | G1/8"X28 | R1/4"X19 | 24.3 | 25.5 | 14 | |
| | G1/4"X19 | R1/4"X19 | 29 | 25.5 | 14 | |
| | G1/4"X19 | R1/8"X28 | 29 | 23.5 | 14 | |
| | G1/4"X19 | R3/8"X19 | 30 | 28.5 | 16 | |
| | G3/8"X19 | R3/8"X19 | 31.5 | 28.5 | 16 | |
| | G3/8"X19 | R1/4"X19 | 31.5 | 26.5 | 16 | |
| | G3/8"X19 | R1/2"X14 | 36 | 36 | 22 | |
| | G1/2"X14 | R1/2"X14 | 38 | 36 | 22 | |
| | G1/2"X14 | R3/8"X19 | 38 | 32.5 | 22 | |
| | G1/2"X14 | R3/4"X14 | 41 | 43.5 | 27 | |
| | G3/4"X14 | R3/4"X14 | 43 | 43.5 | 27 | |
| | G3/4"X14 | R1/2"X14 | 43 | 39.5 | 27 | |
| | G3/4"X14 | R1"X11 | 47 | 50 | 33 | |
| | G1"X11 | R1"X11 | 48.5 | 50 | 33 | |
| | G1.1/4"X11 | R1.1/4"X11 | 57 | 56.5 | 41 | |
| | G1.1/2"X11 | R1.1/2"X11 | 61 | 62.5 | 48 | |
| | G2"X11 | R2"X11 | 73.2 | 74.2 | 63 | |